

SECTION II

TM 10-3930-242-24P

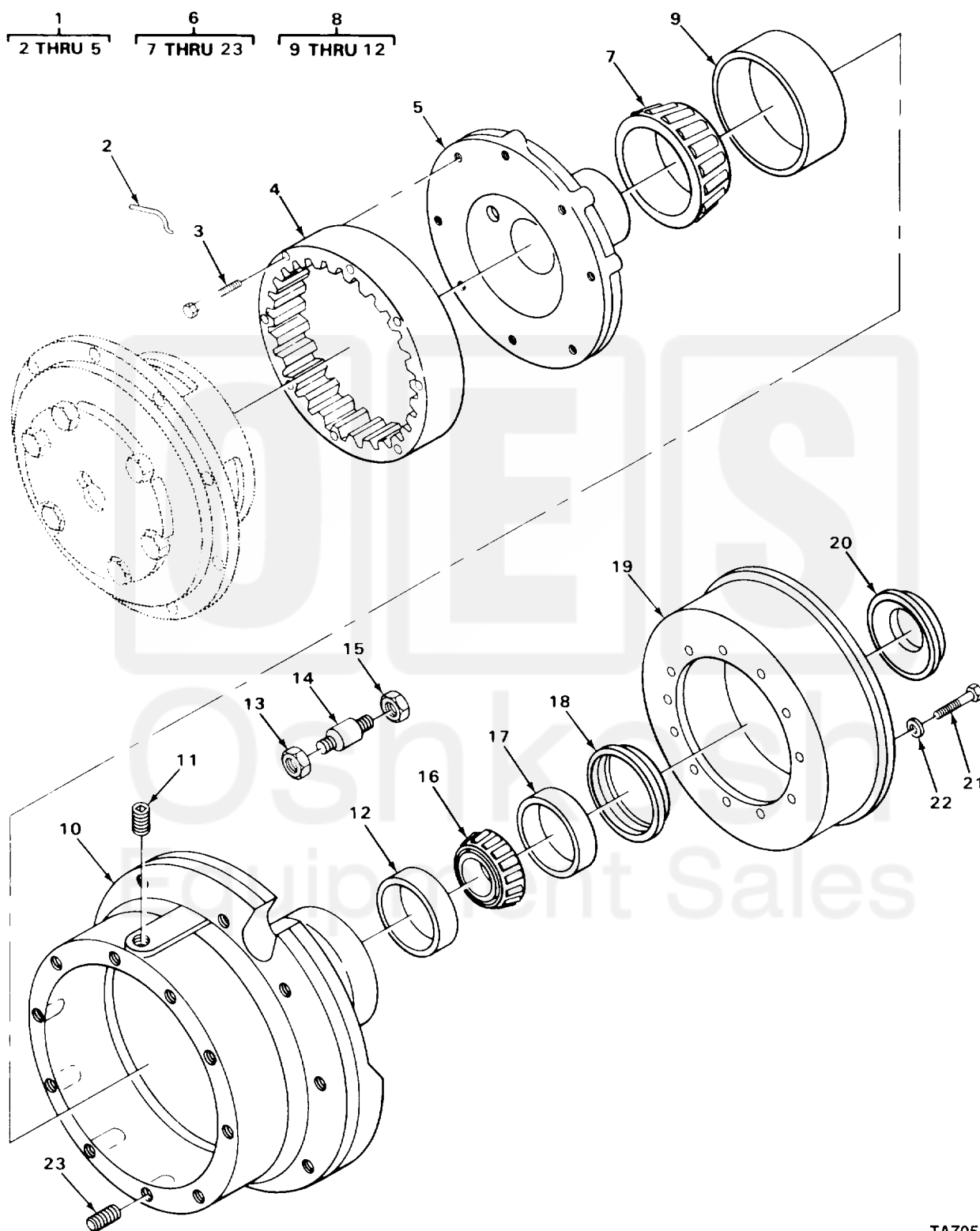

TA705453

FIGURE 127. HUB AND BRAKEDRUM ASSEMBLY.

Current part is item (12) on diagram. Available at www.oshkoshequipment.com

ITEM NO	SMR CODE	CAGEC	PART NUMBER	DESCRIPTION AND USABLE ON CODES (UOC)	QTY
GROUP 13 WHEELS AND TRACKS					
GROUP 1311 WHEEL ASSEMBLY					
FIG. 127 HUB AND BRAKEDRUM ASSEMBLY					
1	PAFZZ	03504	108331	HUB,WHEEL,VEHICULAR INTERNAL	4
2	MFFZZ	19207	1989105-24	.WIRE,LOCK INTERNAL GEAR SCREW MTG, MAKE FROM WIRE P/N 4CS962	1
3	PAFZZ	10988	L33022	.BOLT,MACHINE HEAD INTERNAL GEAR TO HUB	8
4	PAFZZ	03504	106059	.GEAR,INTERNAL PLANETARY	1
5	XDFZZ	12603	108332	.HUB,INTERNAL GEAR	1
6	PAFZZ	03504	118117	HUB AND DRUM ASSEMB FRONT AND REAR AXLE ASSEMBLY	4
7	PAFZZ	60038	56418	.CONE AND ROLLERS,TA HUB AND DRUM	1
8	PFFFF	03504	118118	.HUB,WHEEL,VEHICULAR	4
9	PAFZZ	60038	56650	..CUP,TAPERED ROLLER BEARING HUB	1
10	XAFZZ	12603	118119	..HUB	1
11	PAOZZ	89749	1307337	..PLUG,PIPE,MAGNETIC DRUM	1
12	PAFZZ	60038	592A	..CUP,TAPERED ROLLER BEARING HUB	1
13	PAFZZ	10988	A12522	.NUT,PLAIN,SINGLE BA	10
14	PAFZZ	03504	103445	.STUD,SHOULDERED WHEEL MTG	10
15	PFFZZ	96906	MS35692-62	.NUT,PLAIN,SLOTTED,H WHEEL STUD	10
16	XDFZZ	60038	593	.CONE AND ROLLERS,TA HUB AND DRUM	1
17	PAFZZ	03504	119244	.SPACER,SPECIAL	1
18	PAFZZ	03504	118143	.SEAL,PLAIN ENCASED HUB AND DRUM	1
19	PAFZZ	03504	118120	.BRAKE DRUM	1
20	PAFZZ	03504	106545	.DEFLECTOR,DIRT AND	1
21	PAFZZ	03504	118391	.BOLT,MACHINE HEAD DRUM MOUNTING	12
22	PAFZZ	53496	HD224	.WASHER,FLAT DRUM MTG	12
22	PAFZZ	35301	20-502	UOC:CQK,U72 .WASHER,FLAT WHEEL STUD	12
23	PAFZZ	10988	L33017	UOC:CMQ,CMQ,U73,U74 .STUD,PLAIN	5

END OF FIGURE

Current part is item (12) on diagram. Available at www.oshkoshequipment.com